



MHT Lighting

MHT VL TYPE BULB INSTRUCTION MANUAL

MHT VL Type Induction Bulb includes two different structures, intermediate exhaust tube for 12W-120W and bottom side exhaust tube for 150W-250W.

12W-120W VL Bulb Installation and Removal

1. The structure of 12W-120W VL Bulb has a long glass tube (Exhaust Tube) in the center of the bulb that needs to be inserted into the Magnet Center Hole.

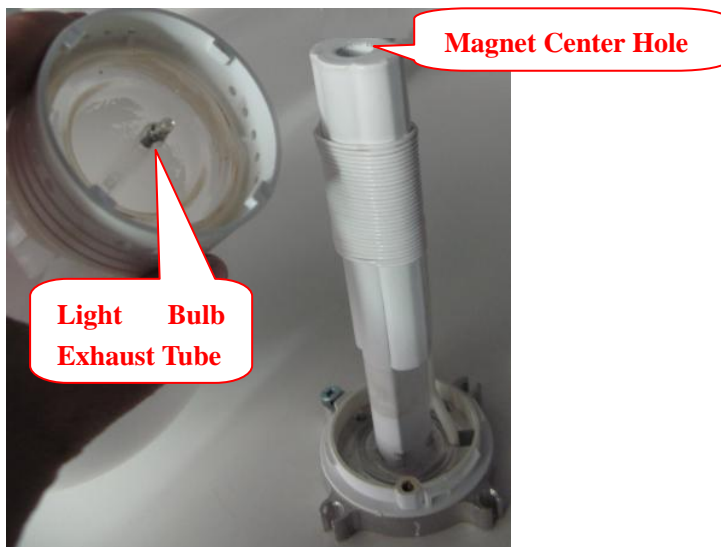

2. Because of the special structure of bulb, installation and removal require special care in order to prevent damage of glass tube.





MHT Lighting

3. Make sure the bulb is all the way down before turning it clockwise and is locked properly and tight.

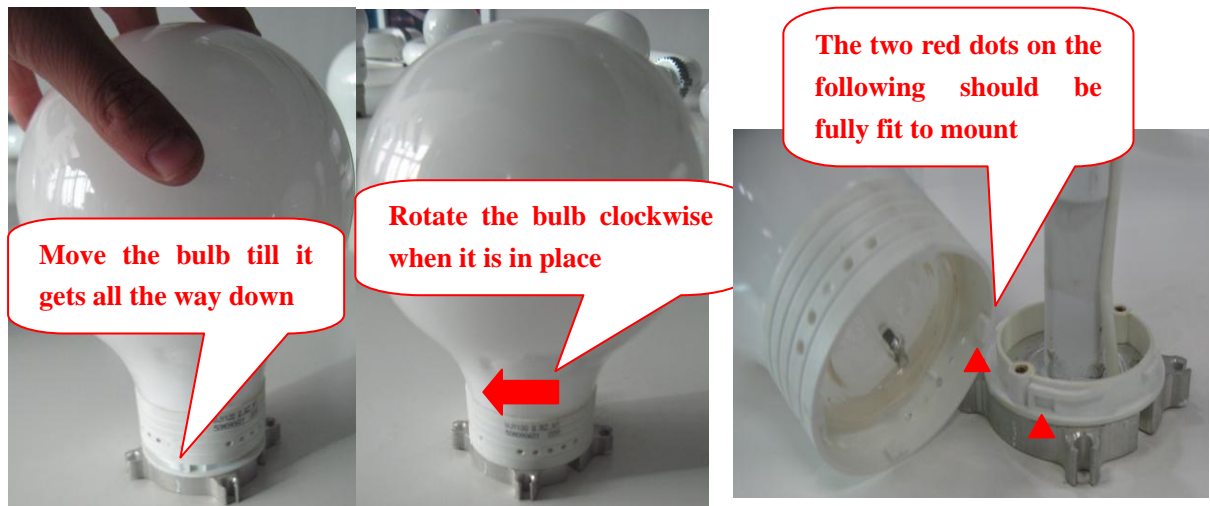

4. Do not shake the bulb side to side when removing the bulb from magnet.

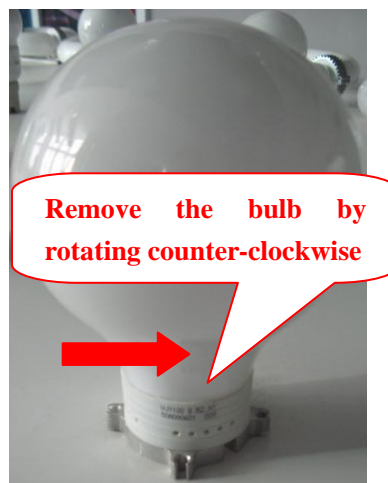



MHT Lighting

150W-250W VL Bulb Installation and Removal

1. For 150W-250W VL Bulb, glass tube is on the bottom side and there is no hole in the center of magnet.



2. Move the bulb all the way down slowly and lock it tight.

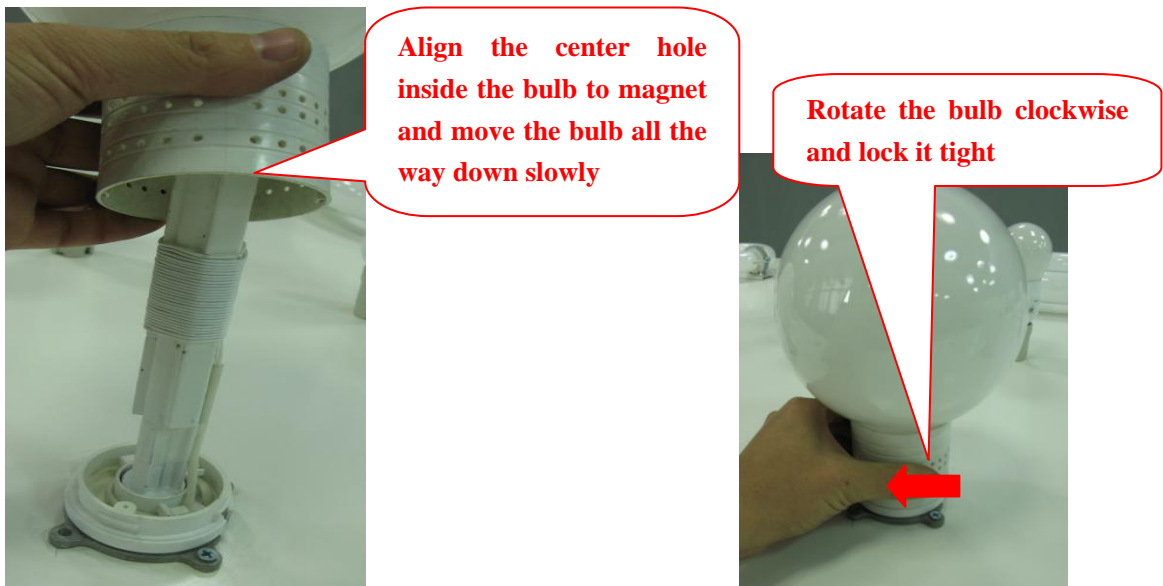

3. Removing the bulb by rotating it counter-clockwise.